

## Features

- Reflow Solderable
- High Luminous Intensity and Low Power Dissipation
- Good Reliability and Long Life
- Lead Free

## Applications

- Optical indicator
- Indoor display
- Backlighting in dashboard and switch
- Flat backlighting for LCD, symbol and display
- General use

**RoHS  
Compliant**

## Specifications

|                 |               |
|-----------------|---------------|
| Dice material   | : AlGaInP     |
| Emmiting Colour | : Red         |
| Lens colour     | : Water Clear |

## Electrical and Optical Characteristics at Ta=25°C

| Parameter           | Symbol | Min. | Typ | Max | Units | Test conditions |
|---------------------|--------|------|-----|-----|-------|-----------------|
| Forward voltage     | VF     | 1.8  | -   | 2.4 | V     | IF=20mA         |
| Reverse Current     | IR     | -    | -   | 10  | uA    | VR=5V           |
| Dominant wavelength | λd     | 626  | -   | 638 | nm    | IF=20mA         |

## Absolute Maximum Ratings at Ta=25°C

| Parameter                     | Symbol | Rating      | Units |
|-------------------------------|--------|-------------|-------|
| Power Dissipation             | Pd     | 48          | mW    |
| DC Forward Current            | IF     | 20          | mA    |
| Peak Forward Current [1]      | IFP    | 75          | mA    |
| Reverse Voltage               | VR     | 5           | V     |
| Electrostatic Discharge (HBM) | ESD    | 2000        | V     |
| Operating Temperature         | Topr   | -40 to +85  | °C    |
| Storage Temperature           | Tstg   | -40 to +100 | °C    |

Notes:

1. 1/10 Duty cycle, 0.1ms pulse width.
2. Measurement Errors: Forward Voltage: ±0.1V
3. The tolerance of wave length ±1nm

## Selection Guide

| Part Number | Chip materials | Lens Type   | Luminous intensity (mcd) @ 20mA |     |     | Viewing Angle |
|-------------|----------------|-------------|---------------------------------|-----|-----|---------------|
|             |                |             | Min                             | Typ | Max |               |
| MP008285    | Red (AlGaInP)  | Water Clear | 30                              | -   | 100 | 2θ1/2<br>120  |

Note:

1. 2θ1/2 is the angle from optical centerline where the luminous intensity is 2θ1/2 the optical centerline value.
2. The above luminous intensity measurement allowance tolerance ±10%

## Typical optical characteristics curves

Ambient Temperature VS. Forward Current

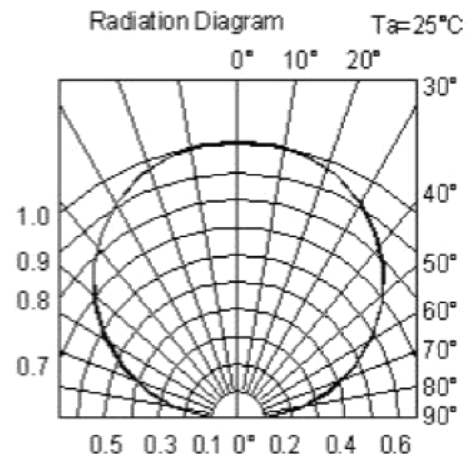
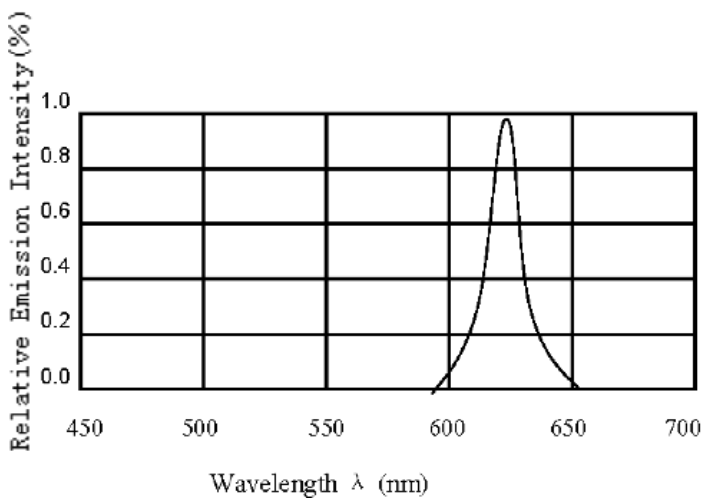
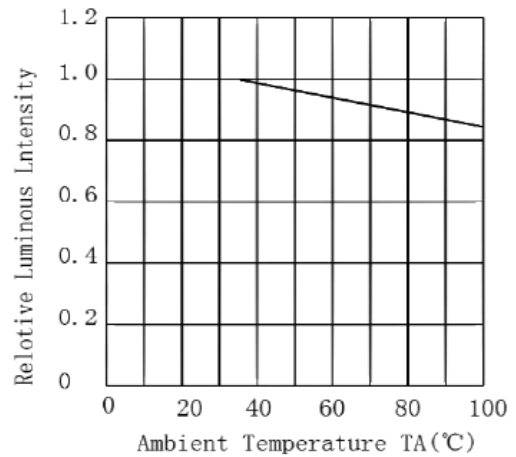
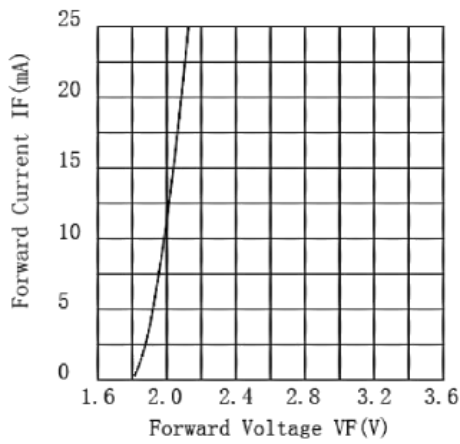
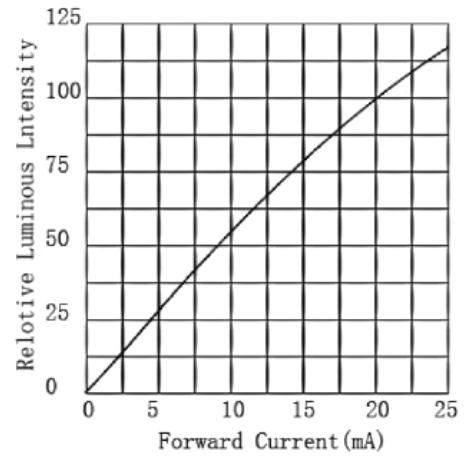
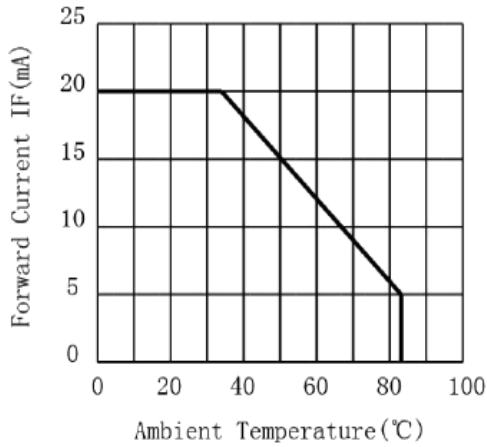

## Dimensions

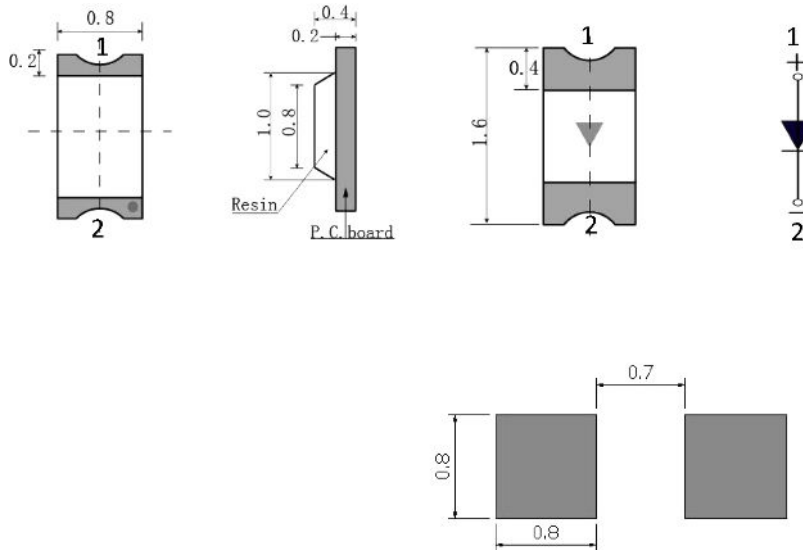

## Notes

1. All dimension tolerance is  $\pm 0.2\text{mm}$  unless otherwise noted
2. All PCB and markings are subject to change without prior notice

Dimensions : Millimetres

## SMT Reflow Soldering Instructions

1. High temperature welding recommended no more than 2 times
2. When soldering , do not put stress on the LEDs during heating
3. Reflow temperature distribution (Acc.to J-STD-020D)

| Profile feature                                 | Sn-Pb Eutectic Assembly |             | Pb-Free Assembly  |                  |
|---|-------------------------|-------------|-------------------|------------------|
|   | Large body              | Small body  | Large body        | Small body       |
| Average ramp-up rate (TL to Tp)                 | 3°C / second max.       |             |                   |                  |
| Preheat   | 100°C                   |             | 150°C             |                  |
| -Temperature Min (TSmin)                        | 150°C                   |             | 200°C             |                  |
| -Temperature Max (TSmx)                         | 60 to 120 seconds       |             | 60 to 180 seconds |                  |
| -Time (min to max) (ts)                         |                         |             |                   |                  |
| Tsmx to TL                                      |                         |             | 3°C / second max. |                  |
| -Ramp-up Rate                                   |                         |             |                   |                  |
| Time maintained above                           | 183°C                   |             | 217°C             |                  |
| -Temperature (TL)                               | 60 to 150 seconds       |             | 60 to 150 seconds |                  |
| -Time (tL)                                      |                         |             |                   |                  |
| Peak Temperature (Tp)                           | 225 +0/-5°C             | 240 +0/-5°C | 245 +0/-5°C       | 260 +0/-5°C      |
| Time within 5°C of actual Peak Temperature (tp) | 10 to 30 seconds        |             | 10 to 30 seconds  | 20 to 40 seconds |
| Ramp-down Rate                                  | 6°C / second max.       |             |                   |                  |
| Time 25°C to Peak Temperature                   | 6 minutes max.          |             | 8 minutes max.    |                  |

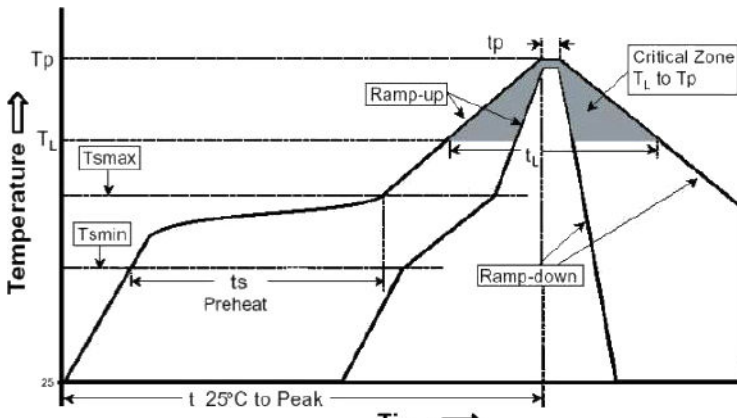

### Soldering iron

1. When hand soldering, the temperature of the iron must be less than 350°C for 3 seconds
2. The hand solder should be done only once

### Part Number Table

| Description                                       | Part Number |
|---|-------------|
| Chip LED, Red, 638nm, 120°, 100mcd, Surface Mount | MP008285    |

**Important Notice :** This data sheet and its contents (the "Information") belong to the members of the AVNET group of companies (the "Group") or are licensed to it. No licence is granted for the use of it other than for information purposes in connection with the products to which it relates. No licence of any intellectual property rights is granted. The Information is subject to change without notice and replaces all data sheets previously supplied. The Information supplied is believed to be accurate but the Group assumes no responsibility for its accuracy or completeness, any error in or omission from it or for any use made of it. Users of this data sheet should check for themselves the Information and the suitability of the products for their purpose and not make any assumptions based on information included or omitted. Liability for loss or damage resulting from any reliance on the Information or use of it (including liability resulting from negligence or where the Group was aware of the possibility of such loss or damage arising) is excluded. This will not operate to limit or restrict the Group's liability for death or personal injury resulting from its negligence. Multicomp Pro is the registered trademark of Premier Farnell Limited 2019.

Newark.com/multicomp-pro  
 Farnell.com/multicomp-pro  
 Element14.com/multicomp-pro